

**MDLA** LANDSCAPE ARCHITECTURE  
SPACE PLANNING  
PLACEMAKING

[www.mdlad.com](http://www.mdlad.com)

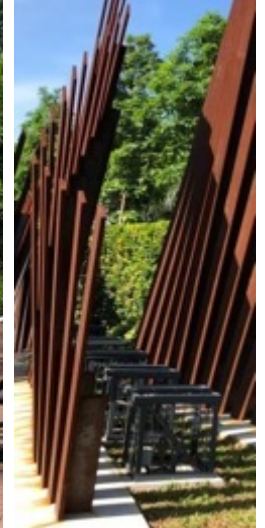
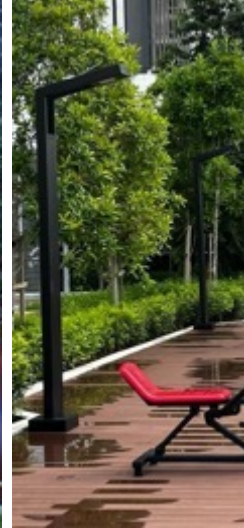
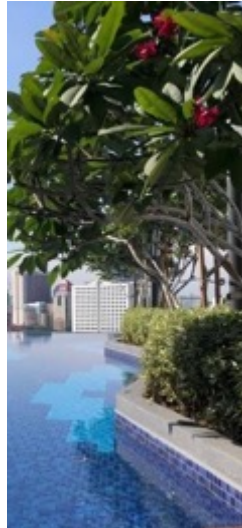

**COMPANY  
PROFILE**

## ABOUT US



### EXCELLENCE AND PROFESSIONALISM

---

In the realm of landscape architecture and design, excellence and professionalism are our guiding principles.

Meticulously crafting outdoor spaces, we blend innovation with environmental stewardship, ensuring sustainable, aesthetically pleasing environments.

Our commitment to quality and ethical practice defines us in shaping a harmonious and enduring landscape.



### REGISTERED AND EXPERIENCE

---

As a registered company, we bring a wealth of experience and embrace the latest design approaches in landscape architecture.

Committed to innovation, our team blends expertise with contemporary techniques, delivering cutting-edge solutions that elevate outdoor spaces.

Trust us for a harmonious fusion of experience and modern design principles



### PERSONALIZED APPROACH

---

Since 2004, with a dedication to client satisfaction, our company has promised a personalised approach tailored to meet your unique needs.

We prioritize your vision, ensuring every detail is crafted to perfection. Trust us to go beyond expectations, delivering solutions that resonate with your requirements and aspirations.

## OUR PROJETS

MASTER PLANNING &  
TOWNSHIP

1

PARKS & PUBLIC SPACES

2

RESIDENTIAL

3

4

CONDOMINIUM  
& MIX DEVELOPMENT

5

OFFICES &  
INSTITUTIONAL

6

RESORT

7

ART & SPECIAL  
PROJECT

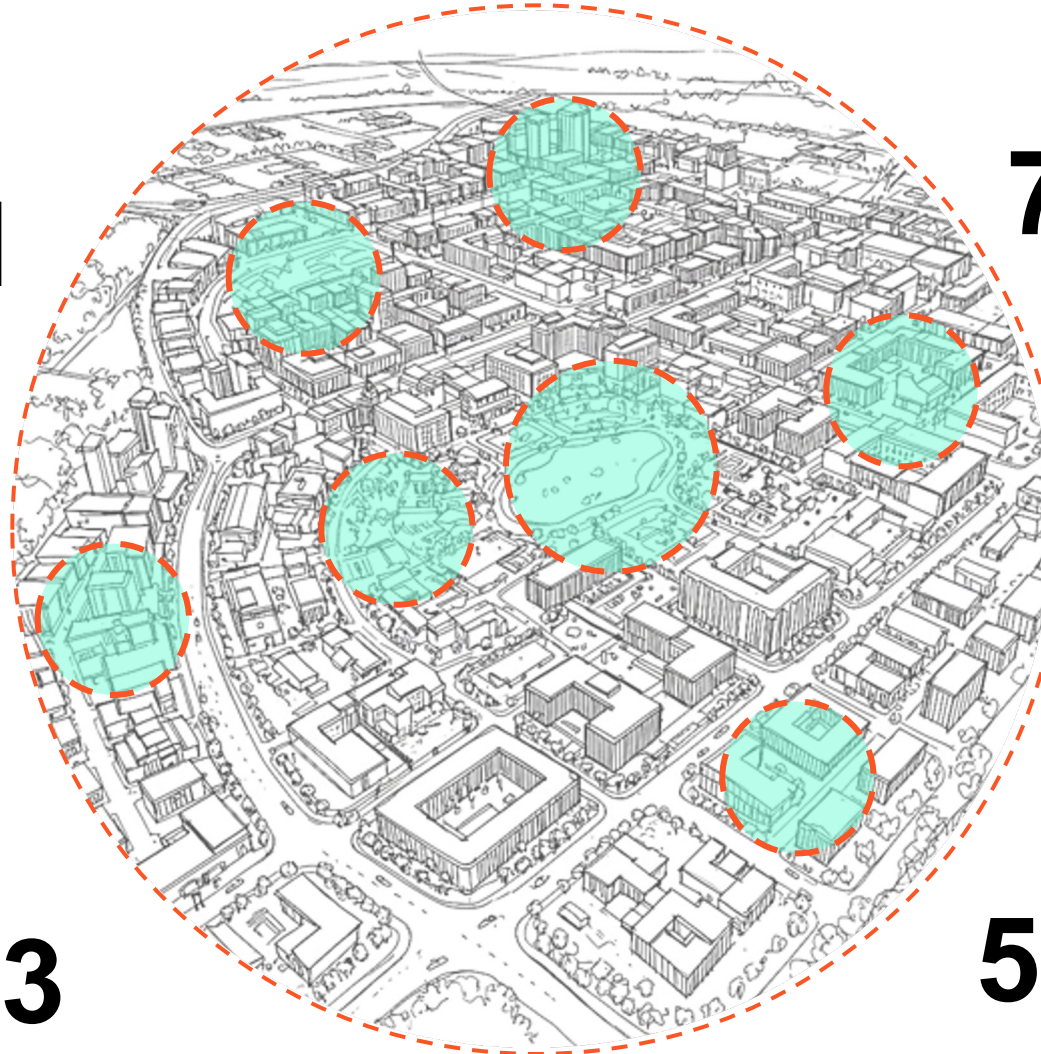

## | OUR TEAMS

 **2** | PRINCIPAL LANDSCAPE ARCHITECTS

 **3** | Project Managers  
SENIOR LANDSCAPE ARCHITECTS

 **1** | PROJECTS ADMIN

 **4** | Design + Technical Teams  
LANDSCAPE ARCHITECTS

 **2** | QUANTITY SURVEYORS

 **2** | GRADUATE LANDSCAPE ARCHITECTS

 **2** | RESIDENT LANDSCAPE ARCHITECTS



## 14 AWARDS

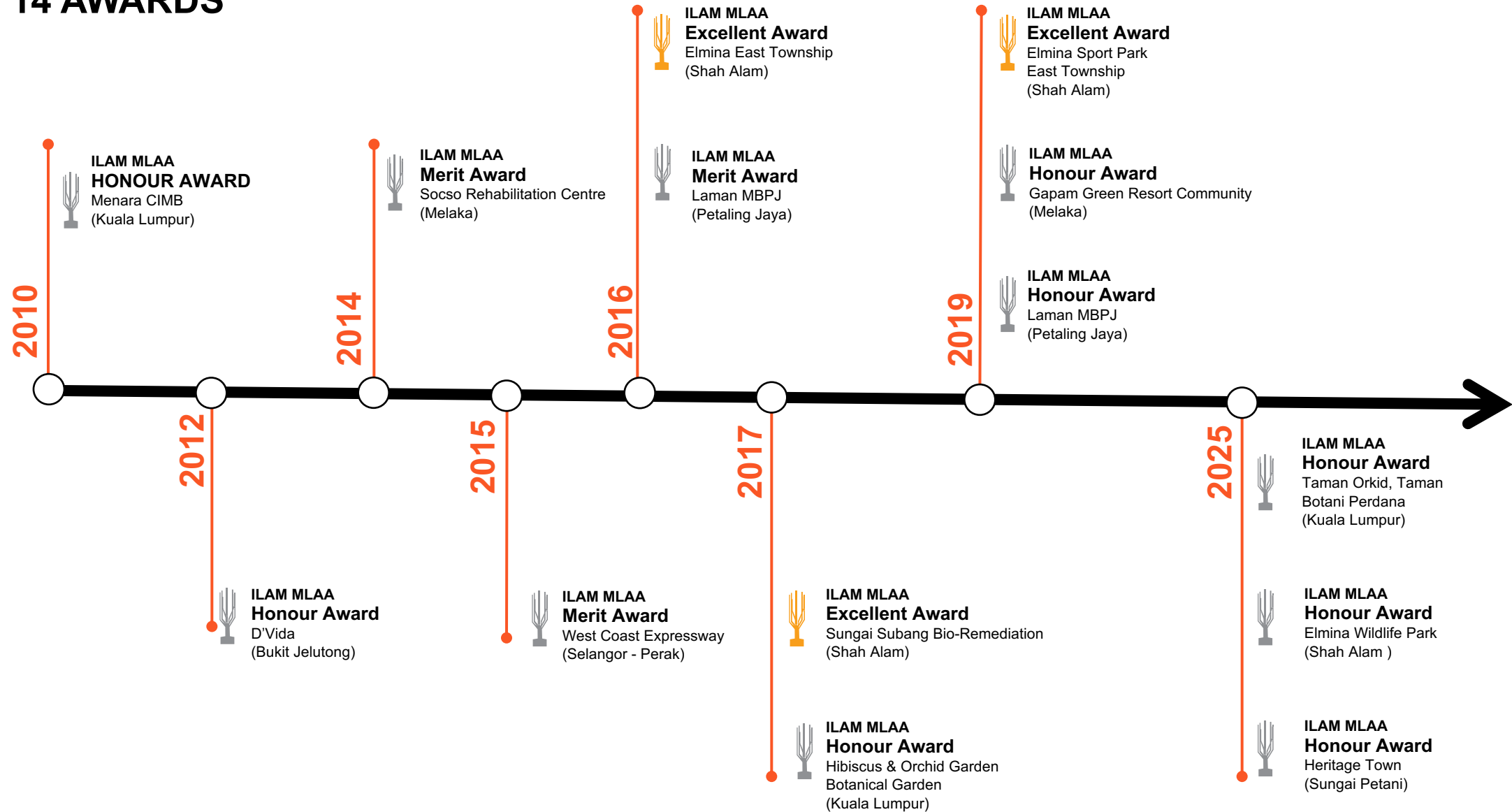

## OUR PROJETS

### MASTER PLANNING & TOWNSHIP

Elmina East, Shah Alam  
Bandar Bukit Raja 3, Klang  
Mutiara Hills, Semenyih  
Sungai Petani OIB  
VBP Industial Park  
Emerld, Rawang  
Zen Bestari, Cyberjaya  
Salak South, Kuala Lumpur  
Bandar Bukit Raja, Klang  
Mahkota Hills, Semenyih  
Bandar Hevea Feldajaya, Jempol  
Uda Sungai Pelek, Sepang  
Uda Desaru, Johor Baru  
Bendang Makmur  
Alam Impian, Shah Alam  
Gapam Community Resort, Melaka

### OFFICES & INSTITUTIONAL

Elmina Pavilion  
CIMB Tower, Kuala Lumpur Bank  
Negara Malaysia, Melaka  
D'Vida, Bukit Jelutong  
Hospital Rompin, Rompin  
Q Sentral, Kuala Lumpur  
KL Sentral, Kuala Lumpur  
Sime A8  
Nu Mayang Mall, Kuala Terangganu  
PJ City, Petaling Jaya  
Anjung, Putrajaya  
SOCSO Rehabilitation Centre, Melaka

### RESORT

Royal Belum, Gerik  
Community Village & The House  
Hibiscus 2, Port Dickson

### CONDOMINIUM & MIX DEVELOPMENT

Sentral Suite, Kuala Lumpur Imperia,  
Puteri Harbor PPAM Setapak  
PJ Midtown, Petaling Jaya  
Conexion, Cyberjaya  
Selayang Mutiara Sentral, Selayang  
Clio, Cyberjaya  
558, Cyberjaya  
Kenchanis  
Inspira, Gombak  
Monterez PKNS Tower  
Selayang Hot Spring, Selayang Kepong Mix  
Development, Kelana Jaya

### PARKS & PUBLIC SPACES

River Park, Semenyih  
Laman MBPJ  
Laman Mayang  
Taman Orkid & Taman Bunga Raya, Kuala Lumpur  
Taman Bunga Raya, Shah Alam  
Wildlife Park, Elmina East  
Urban Forest, Elmina East  
Elmina Garden, Pond 4 & 5  
Dataran Warisan KKB

### ART & SPECIAL PROJECT

Antara Gapi Putera Height  
Selangor Cyber Valley  
West Coast Expressway  
Nilai Impian 2, Nilai  
Masjid Proton, Tanjung Malim  
E3, Shah Alam  
Aliya, Sepang  
Surau & Tadika, Denai Alam  
Surau & Tadika, Bukit Jelutong  
Dewan, Bukit Jelutong  
Kompleks Kejiranan 18  
Industrial Gateway BBR2  
11E, BBR2  
TEMU2, Elmina East

### RESIDENTIAL

Casira 2 Dayana  
Trilia Anira 2  
Cendrawasih R14  
R14, BBR 3  
R15, BBR 3  
I12, BBR 2  
SB7, Serenia City  
PPR Kota Setar  
Taman Rakyat SS13

## ELMINA EAST

### TOWNSHIP + PARKS

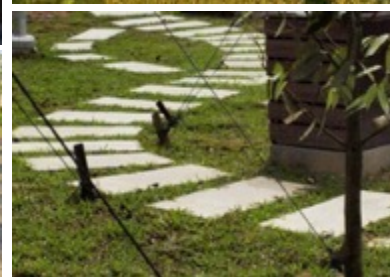

Elmina East is one of the featured developments in the City of Elmina, which consists of 5,000 acres of mixed development with the intention of raising the quality of life.

Blessed with 300 acres worth of gardens and parks alongside social spaces and wellness development.

Elmina East promises to cover all aspects of life through eight (8) elements of wellness: social, environmental, intellectual, family, occupational, physical, emotional, and spiritual wellness.





## SUNGAI SUBANG, ELMINA EAST, SHAH ALAM

TOWNSHIP + PARKS



Through the water mediation of the Sungai treatment, the bioremediation of Sungai Subang will improve the health of the river corridor and revive the habitat, creating an ecological approach. As a result, the river will become livable and hold great potential for community use.





# **SOC SO REHAB CENTER, MELAKA**

INSTITUTIONAL

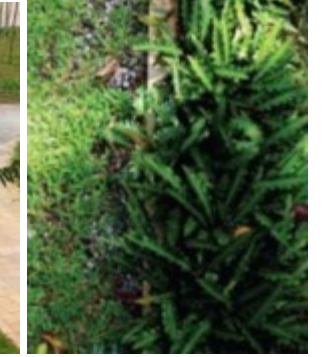
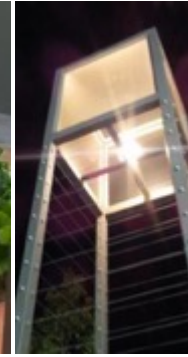



## SPORTS PARK, ELMINA EAST, SHAH ALAM.

TOWNSHIP + PARKS



The Elmina Sports Park is designed with sustainable play structures that are durable, low-maintenance, and safe for users. Additionally, it will offer dynamic spaces featuring a variety of elevated structures and decision-making challenges, enhancing users' sense of adventure in the area.





## GAPAM RESORT, MELAKA

RESORT **my nbs**  
Nature-based Solutions



Experience a breath of fresh air and a refreshing twist on the urban landscape, as you enjoy a rejuvenating natural environment that captures the essence of "heaven on earth." It offers the perfect escape from the hustle and bustle of the draining concrete jungle.

Gapam Green Resort Community (GGRC) will be a vibrant, modern neighborhood, home to over 5,000 local and international residents. Designed to promote a healthy work-life balance, it features a variety of enchanting outdoor amenities for all to enjoy.



## LANAMAN MBPJ, PJ

URBAN PARK





# D'VIDA, BUKIT JELUTONG

COMMERCIAL **my nbs**  
Nature-based Solutions





# CIMB, KUALA LUMPUR

CORPORATE BUILDING

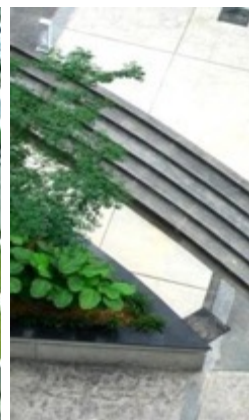



# TAMAN ORKID, TAMAN BOTANI KUALA LUMPUR

PARKS





# **ELMINA EAST, SHAH ALAM**

TOWNSHIP + PARKS





## A7, SERENIA CITY

RESIDENTIAL

COMPLETED PROJECT





# **ELMINA EAST, SHAH ALAM**

TOWNSHIP + PARKS





# **BELUM RESORT, TEMENGOR, PERAK**

RESORT

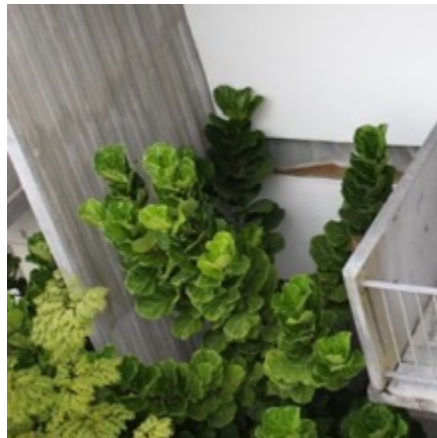



# **PUTERI HARBOUR, ISKANDAR PUTERI, JOHOR**

## **APARTMENT**





# **SD GUTHRIE HQ, ARA DAMANSARA, PETALING JAYA**

## **OFFICE COURTYARD**

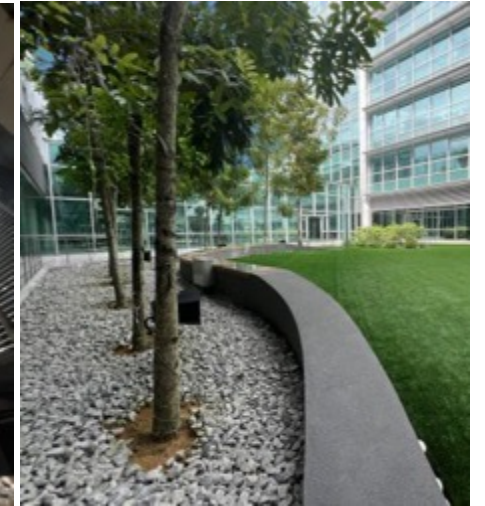



## **PJ CITY OFFICE COURTYARD, PETALING JAYA**

### OFFICE PLAZA





## **MINI SPORT PARK, ELMINA EAST, SHAH ALAM**

TOWNSHIP + PARKS





# CLIO, PUTRAJAYA

APARTMENT





# CONEXION, PUTRAJAYA

APARTMENT





## **PJ MIDTOWN, PETALING JAYA**

APARTMENT





# **THE MULIA RESIDENCES, CYBERJAYA**

TOWNSHIP + PARKS





## SENTRAL SUITES, KL

APARTMENT

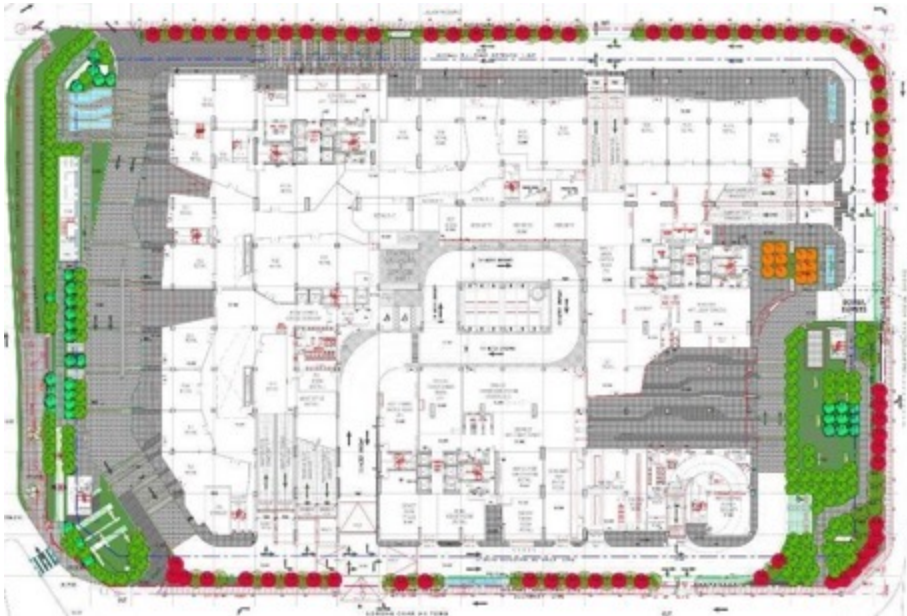



## **SENTRAL SUITES, KL**

APARTMENT

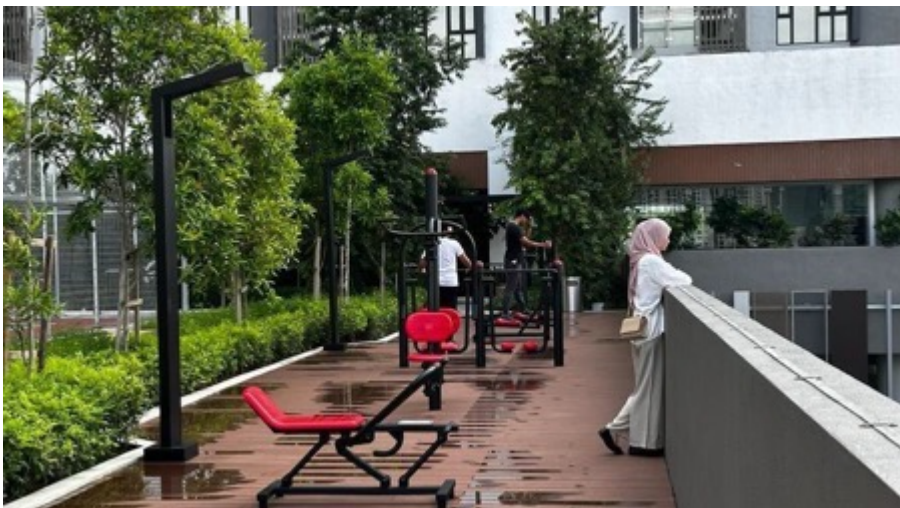



## **INDUSTRIAL GATEWAY, BBR**

TOWNSHIP + ENTRANCE SIGNAGE





# **DIYANA, NILAI IMPIAN**

RESIDENTIAL





# TRILIA, BUKIT JELUTONG

RESIDENTIAL





## INSPIRA, AMPANG

APARTMENT

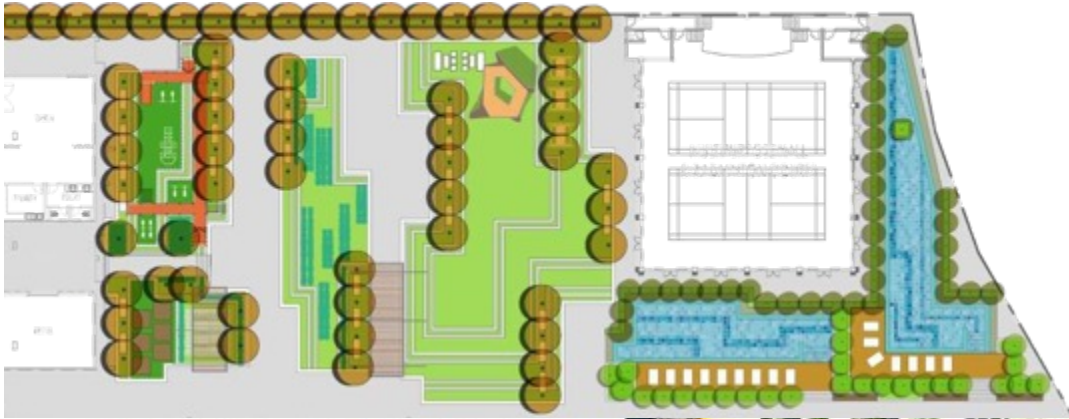



# **WIDLIFE PARK (PHASE 1), ELMINA EAST**

TOWNSHIP + PARKS





# DATARAN WARISAN, KUALA KUBU BHARU

PUBLIC PARKS + PLACEMAKING





# VISION BUSINESS PARK, NILAI

TOWNSHIP + PARKS **my nbs**  
Nature-based Solutions





## **BANDAR BUKIT RAJA 2**

TOWNSHIP + PARKS **my nbs**  
Nature-based Solutions





## **BANDAR BUKIT RAJA 3**

TOWNSHIP + PARKS

my  
nbs  
Nature-based Solutions





# WETLAND NATURE PARK BBR3

TOWNSHIP + PARKS

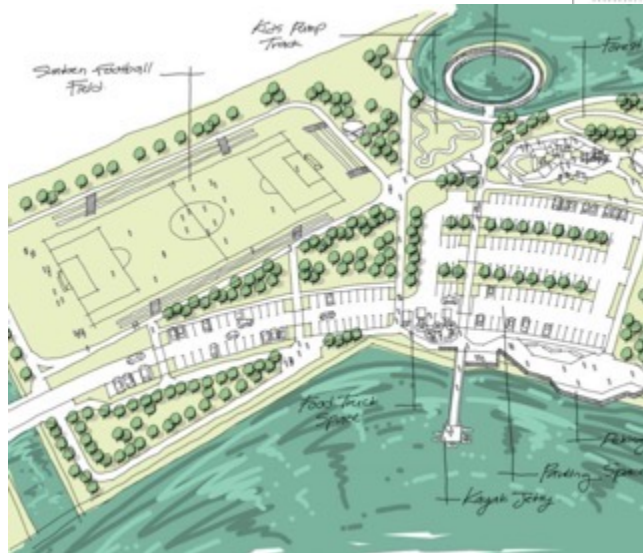
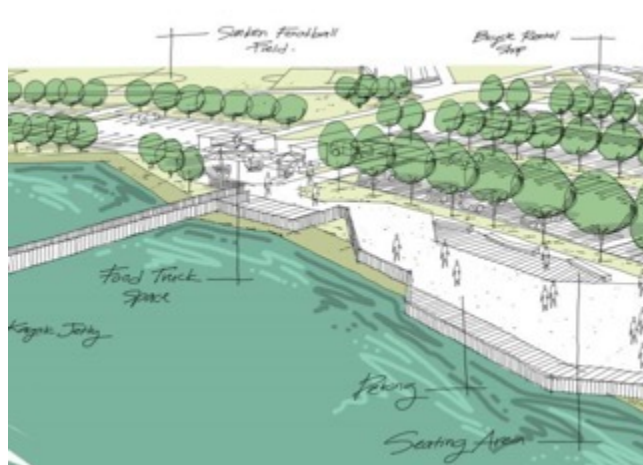



# **WIDLIFE PARK, ELMINA EAST**

TOWNSHIP + PARKS





# RIVER PARK, MUTIARA HILLS

TOWNSHIP + RIVER PARK





# **SUNGAI PETANI MASTERPLAN, OIB**

TOWNSHIP + PARKS





## **CASIRA 2, BANDAR BUKIT RAJA**

RESIDENTIAL **my nbs**  
Nature-based Solutions





## ADIRA, BANDAR BUKIT RAJA

RESIDENTIAL **my nbs**  
Nature-based Solutions

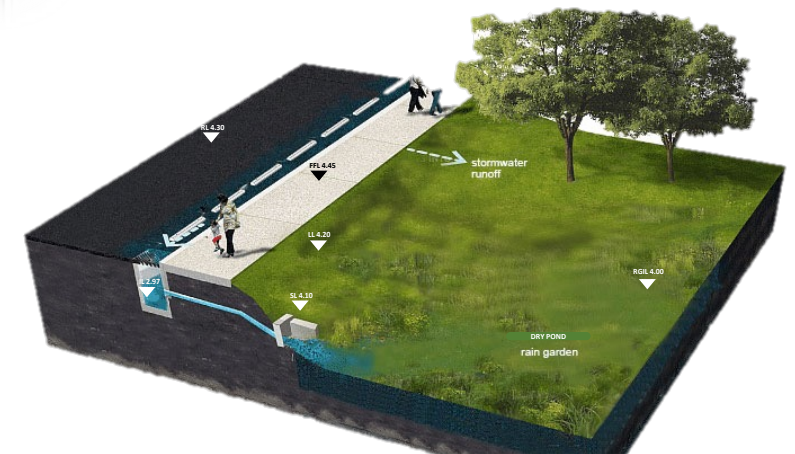



## **R9, BANDAR BUKIT RAJA**

RESIDENTIAL **my nbs**  
Nature-based Solutions





## **R14, BANDAR BUKIT RAJA**

RESIDENTIAL





# **BAYU, SERENIA CITY**

RESIDENTIAL





# **11<sup>TH</sup> AVENUE, BANDAR BUKIT RAJA**

COMMERCIAL





# **SUNGAI PETANI MASTERPLAN, KEDAH**

URBAN DESIGN





# ELMINA VELODROME, ELMINA EAST

TOWNSHIP + PARKS





# **TAMAN BUNGA RAYA, SHAH ALAM**

PUBLIC PARKS





## CONTACT US



### **MAIN OFFICE**

No. 28 -G, Jalan Musytari AQ U5/AQ, Subang Pelangi,  
Seksyen U540150 Shah Alam



+60 3-7734 1144

General : [mdladesignsb@gmail.com](mailto:mdladesignsb@gmail.com)

Project : [mdla.designs@gmail.com](mailto:mdla.designs@gmail.com)



### **NORTHERN OFFICE**

No A26, 1st Floor, Jalan Penaga 1, Taman Penaga,  
08000, Sungai Petani, Kedah, Malaysia



[www.mdlad.com](http://www.mdlad.com)